

Element SSK-V

27" Touch Screen Self-Service Kiosk



Discover the perfect blend of value, style, and efficiency with the **Element SSK-V Kiosk Series**. Designed for modern retail environments, this sleek and compact kiosk seamlessly integrates into any store layout, optimising space without compromising aesthetics.

Featuring a 27" touch screen, the Element SSK-V provides an intuitive, user-friendly interface that enhances customer interaction. Its stylish design fits effortlessly into various store environments, adding a touch of modern elegance. Mounting options include Wall, Desktop, and Pole stands for versatile setup.

With multiple payment add-on options, including EFT, MSR, or both, the Element SSK-V accommodates a wide range of customer preferences. Advanced scanning capabilities, featuring a 1D and 2D barcode scanner, read effortlessly from phone screens, streamlining the checkout process.

Designed for simplicity, the Element SSK-V ensures hassle-free maintenance, reducing downtime and costs. Elevate your store's efficiency and customer experience with the Element SSK-V kiosk, where innovative design meets robust functionality.

- > Multiple Platform Processors: Intel Celeron J6412, Core i3 and i5 (11th Gen) and Android RK3568
- > Supports Android, Linux and Microsoft operating systems
- > 27" Touch Screen 1920 x 1080 Full HD, PCAP Touch
- > Mounting options include Wall, Desktop and Pole stands
- > 1D/2D Barcode Scanner included



Multiple Platform processors

- Intel® Celeron® J6412 (1.5M Cache, up to 2.60 GHz)
- Intel® Core™ i3-1115G4 (6M Cache- up to 4.10 GHz)
- Intel® Core™ i5-1135G7 (8M Cache- up to 4.20 GHz- with IPU)
- RK3568 Quad-core Cortex-A55 up to 2.0GHz

Printer
 80/58 mm Thermal Printer
 Independent door opening
 Electric button
 Easy to change paper
 Simple maintenance



Barcode Scanner
 1D/2D Barcodes
 Can scan phone screen

Payment Device Mounting option

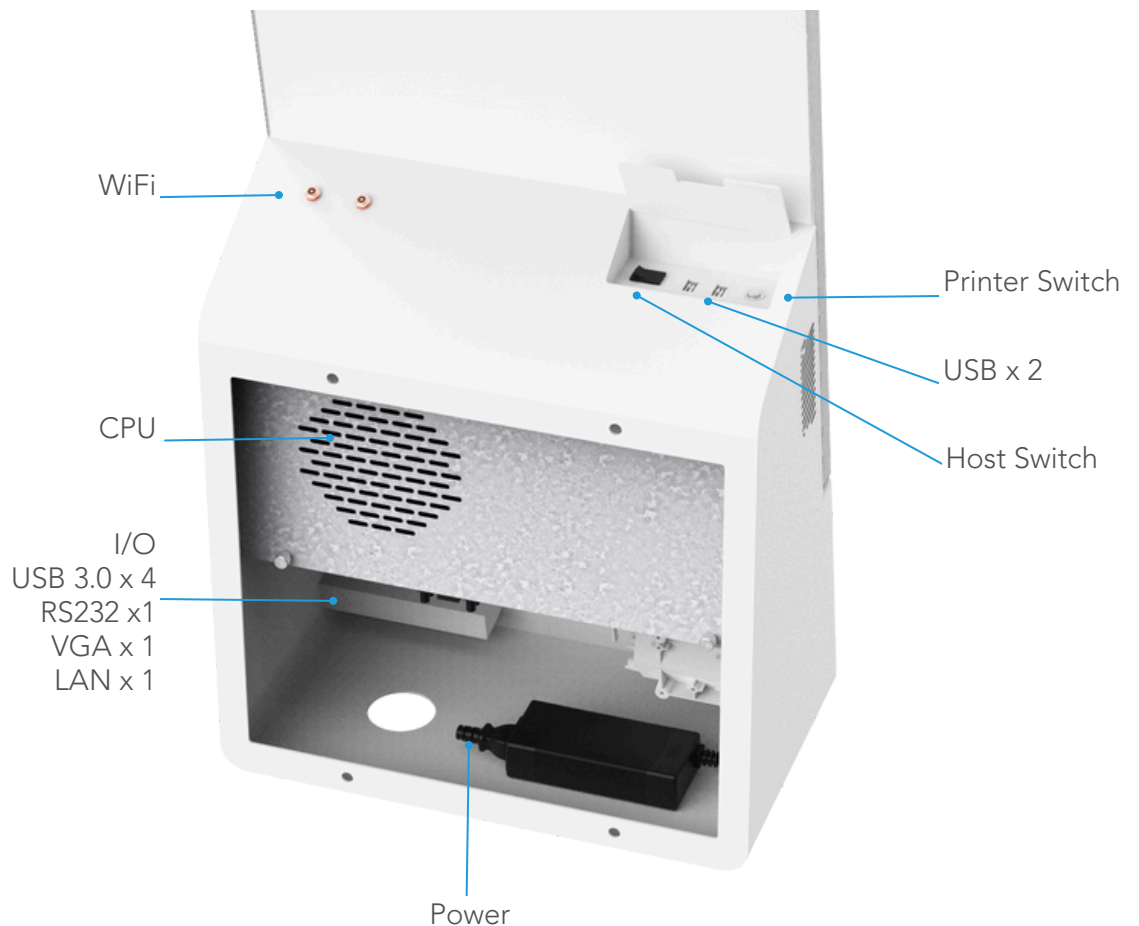

VERSATILE INSTALLATION OPTIONS

Stand

Wall Mount

Counter Top



Stock code	Description
KIETSSKV001	ELEMENT KIOSK SSK-V J6412 8/128 27P 2D/PR W11 WALL
KIETSSKV002	ELEMENT KIOSK SSK-V J6412 8/128 27P 2D/PR W11 DESK
KIETSSKV003	ELEMENT KIOSK SSK-V J6412 8/128 27P 2D/PR W11 POLE
KIETSSKV004	ELEMENT KIOSK SSK-V I3 8/128 27P 2D/PRT W11 WALL
KIETSSKV005	ELEMENT KIOSK SSK-V I3 8/128 27P 2D/PRT W1 DESK
KIETSSKV006	ELEMENT KIOSK SSK-V I3 8/128 27P 2D/PRT W11 POLE
KIETSSKV010	ELEMENT KIOSK SSK-V I5 8/128 27P 2D/PRT W11 WALL
KIETSSKV011	ELEMENT KIOSK SSK-V I5 8/128 27P 2D/PRT W11 DESK
KIETSSKV012	ELEMENT KIOSK SSK-V I5 8/128 27P 2D/PRT W1 POLE
KIETSSKV007	ELEMENT KIOSK SSK-V RK3568 4/16 27P 2D/ AD11 WALL
KIETSSKV008	ELEMENT KIOSK SSK-V RK3568 4/16 27P 2D/P AD11 DESK
KIETSSKV009	ELEMENT KIOSK SSK-V RK3568 4/16 27P 2D/P AD11 POLE

Technical Specifications - SSK-V Self Service Kiosk

Item		Parameter		
		SSK-V Main Unit with J6412 processor (8GB + 128GB), 27 inch Touch Screen, Scanner, Printer and Windows 11 Enterprise	SSK-V Main Unit with i3-1115G4 processor (8GB + 128GB) or i5-1135G7, 27 inch Touch Screen, Scanner, Printer and Windows 11 Enterprise	SSK-V Main Unit with RK3568 processor (4GB + 16GB), 27 inch Touch Screen, Scanner, Printer and Android 11
Specification	Processor	Intel® Celeron® Processor J6412 1.5M Cache, up to 2.60 GHz	Intel® Core™ i3 1115G4 2C/4T 3.0GHz 6M Intel® Core™ i5-1135G7 (8M Cache- up to 4.20 GHz- with IPU)	Rockchip RK3568, Quad-Core ARM Cortex-A55, up to 2.0GHz
	System Memory	DDR4 8GB	DDR4 8GB	DDR4 8GB
	Storage Device	M.2 SATA 128GB	M.2 SATA 128GB	eMMC 16GB
	WiFi	2.4G		
	Power Supply	12V/18W x 1 (2.5)	12V/18W x 1 (2.5)	12V/18W x 1 (2.5)
	Serial Port	RS232 x 1	RS232 x 1	N/A
	Standard USB Port	USB 3.0 x 4, USB 2.0 x 2	USB 3.0 x 4, USB 2.0 x 2	USB 3.0 x 2, USB 2.0 x 4
	Display Port	VGA x 1	HDMI x 1	HDMI x 1
	LAN Port	10/100/1000 Mb x 1	10/100/1000 Mb x 1	10/100/1000 Mb x 1
	Audio	Internal 5W speaker x 2	Internal 5W speaker x 2	Internal 5W speaker x 2
Environment	Operating Condition	0°C - 50°C, 20%RH - 90%RH	0°C - 50°C, 20%RH - 90%RH	0°C - 50°C, 20%RH - 90%RH
	Storage Condition	-20°C - 70°C, 10%RH - 90%RH	-20°C - 70°C, 10%RH - 90%RH	-20°C - 70°C, 10%RH - 90%RH
Screen	LCD	27" TFT LCD		
	Resolution	16:9 1920 x 1080		
	Touch Screen	Projected Capacitive (10-point multi-touch)		
Scanner	2D Scanner International first-line barcode scanner, support 1D&2D and scanning mobile phone screen			
Printer	Printing mode	Line-based thermal printing		
	Printing speed	Up to 200mm/s		
	Paper width	80mm / 58mm		
	Service life of print head	100km		
	Service life of cutter	1 million times		
Payment Terminal Holder	Included			
Operating System	Windows 11 Enterprise	Windows 11 Enterprise	Android 11	
Colour	White	White	White	
Holder Options	Wall Mount Holder	Wall Mount Holder	Wall Mount Holder	
	Counter Top Holder	Counter Top Holder	Counter Top Holder	
	Pole Holder	Pole Holder	Pole Holder	

*Product specifications and data are subject to change without notice (E&OE)